



Califat Coal Mine, St George's Hill, Swannington

Photographic Report Of LIHS Excavation - February 2022

Califat Engine House



A weed control fabric was laid along the winding drum void, covering both the brick pavement at the south end of the void and the clay at the north end.



Califat Coal Mine, St George's Hill, Swannington

Photographic Report Of LIHS Excavation - February 2022



A wooden marker was fixed across the void to delineate the transition from the brick pavement at the south of the void from the clay at the north. The weed control fabric was covered with pea shingle.

Image bottom left is view from the north end, bottom right is from the south end.



This was the last main job of the excavation that began in 2006. The physical part of the dig has now ended, although there are some minor elements to complete.

Work will continue on the interpretation of the site.



Califat Coal Mine, St George's Hill, Swannington

Photographic Report Of LIHS Excavation - February 2022

Califat Engine House Plan

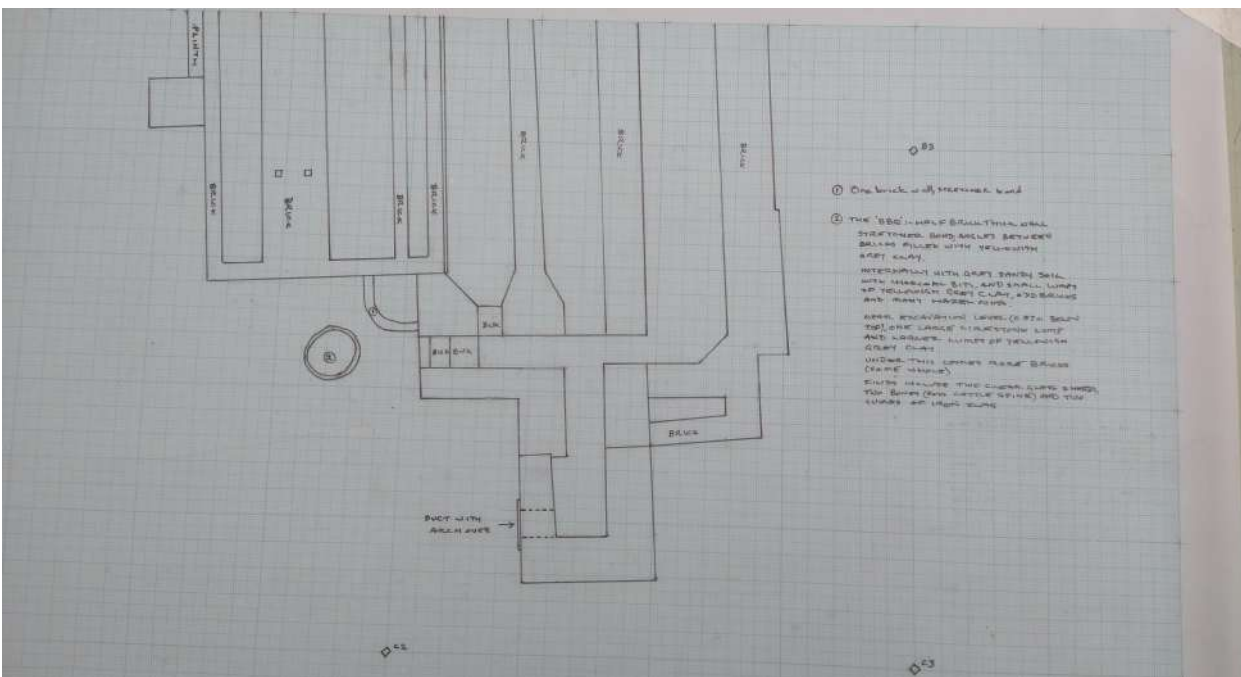
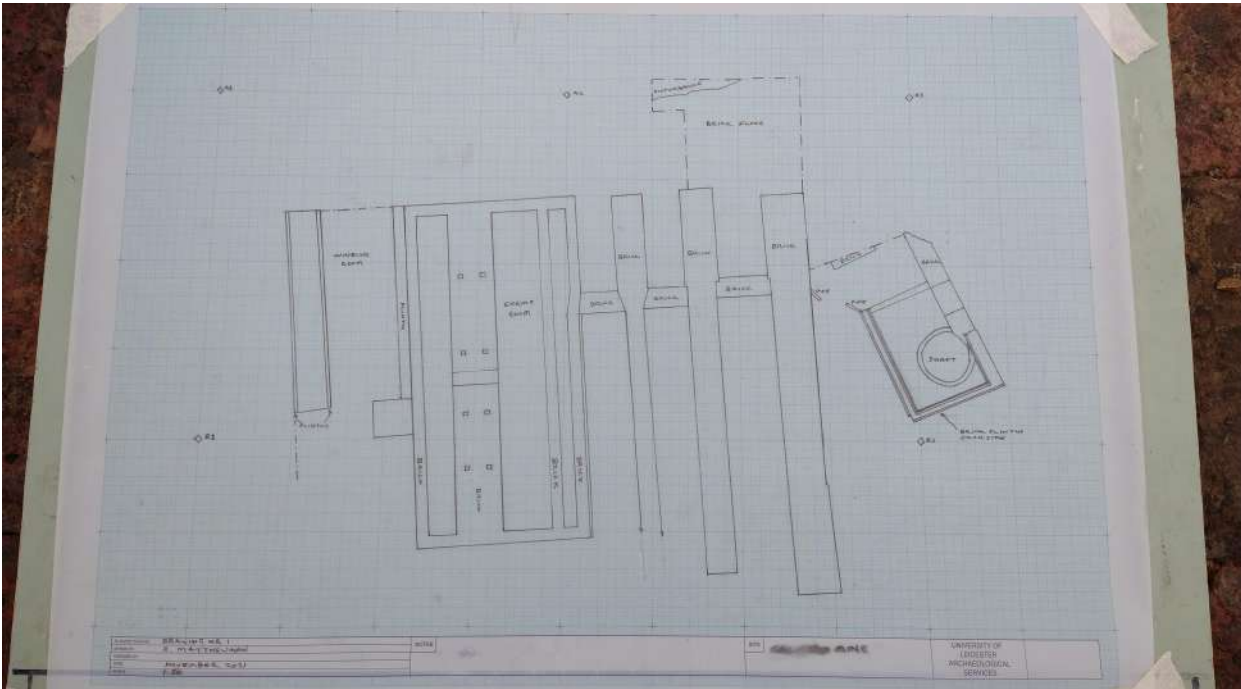

Surveyed scale drawing of engine house complex, made from measurements of the site and buildings, in two parts.



Califat Coal Mine, St George's Hill, Swannington

Photographic Report Of LIHS Excavation - February 2022



Surveyed drawing of engine house site.

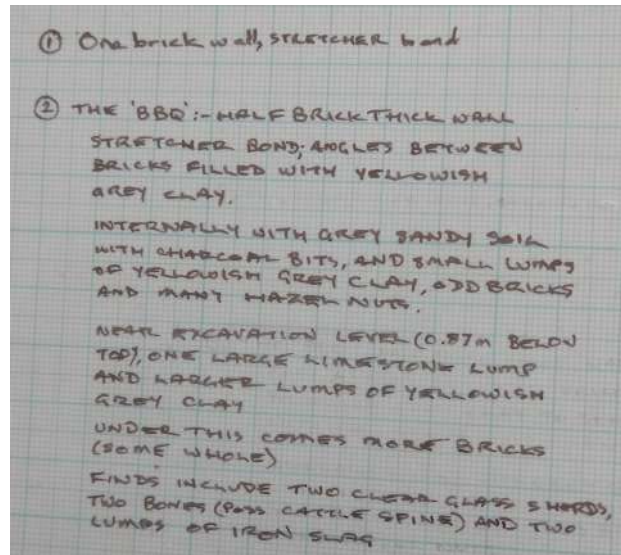

Notes in the drawing.

Miners Cottages

Work continued on exposing the eastern pavement and the French drains at the north eastern corner.